

EXISTING PATH

23 FEB 2010
2/3/2010
FOR A 22 BULL
ANNUAL REPORT
D. H. H.

PACHYMIUM 'DARK BELGIAN'

DIAPYLLA HYBRIDS VARIETATED.

GREVILLEA
'QUIST DANCE'

LAWN

CONVOLVULUS
CAJIFORM

EXISTING
FOOTPATH

NEL CASTLE STREET

RECEIVED
17 FEB 2010

Town of Vincent
22 DEC 2009
Received

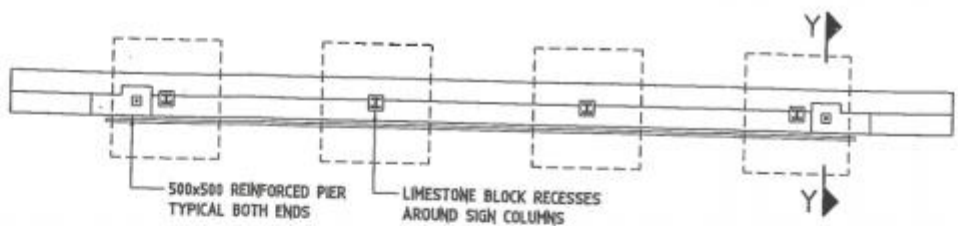

PLAN VIEW

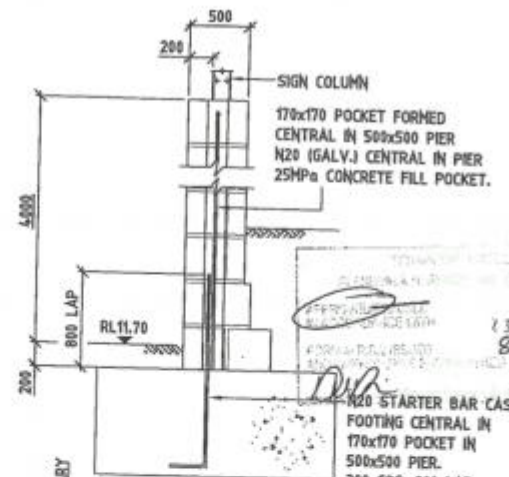
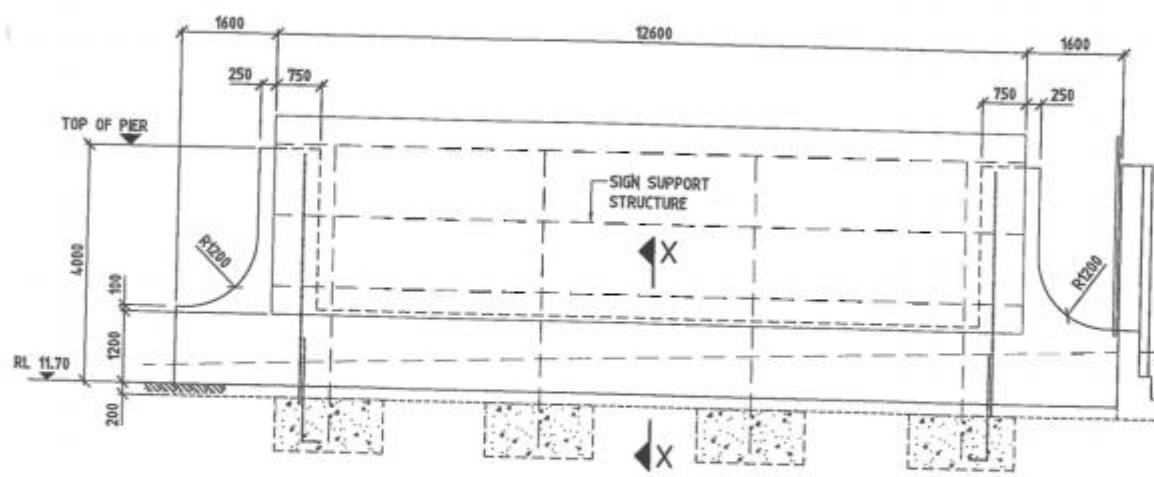

**SECTION Y-Y
SECTION THRU PIER**



**SECTION X-X
RETAINING WALL DETAIL**

APPROVAL
8/3/2010

- RETAINING WALL NOTES**
1. WALL DESIGNED FOR SANDY CONDITIONS FREE OF GROUND WATER.
 2. COMPACTION OF FOUNDATION TO BE A MINIMUM OF 5 BLOWS/300mm FOR 750mm BELOW BASE OF WALL.
 3. LIMESTONE TO HAVE A MINIMUM DENSITY OF 1600kg/m³.
 4. LIMESTONE TO INTERLOCK TO FORM STRONG BOND. ALL VOIDS TO BE FILLED WITH MORTAR.
 5. RE-COMPACT SAND IN FRONT OF WALL PRIOR TO BACKFILLING.
 6. LEAVE WALL A MINIMUM OF 5 DAYS PRIOR TO BACKFILLING.

SECTION B (SECTION A SIMILAR)
REFER DWG S1 FOR SECTION LOCATIONS

NOTE: REFER STANDARD WA BILLBOARDS DRAWINGS FOR SIGN SUPPORT STRUCTURE AND FOOTING DETAILS

Town of Vincent
22 DEC 2008
Received

D				PROJECT	LANDSCAPING & SIGNAGE TO LOT AT CORNER OF NEWCASTLE & LOFTUS ST	DRAWN	ML	OCT '08	<p>CARNEGIE ASSOCIATES PTY LTD CONSULTING ENGINEERS STRUCTURAL DESIGN AND DRAFTING SPECIALISTS Unit 3 48 Foster Road Osborne Park Western Australia 6017 Tel: 9244 1311 Fax: 9244 1022 Email: info@carnegie.com.au</p>	
C				CLIENT	WA BILLBOARDS	CHECKED				
B				TITLE	RETAINING WALL & SIGN SUPPORT STRUCTURE	DESIGNED	PH	OCT '08		
A	ML	08/10/08				APPROVED				
EX.	BY	DATE				CAD REV.	SCALE	JOB No.	ENCL. No.	REV.

TOWN OF VINCENT
 APPROVED FOR CONSTRUCTION
 FOR THE TOWN OF VINCENT
 APPROVED BY
 23 DEC 2009
 8/3/2010
 DWP

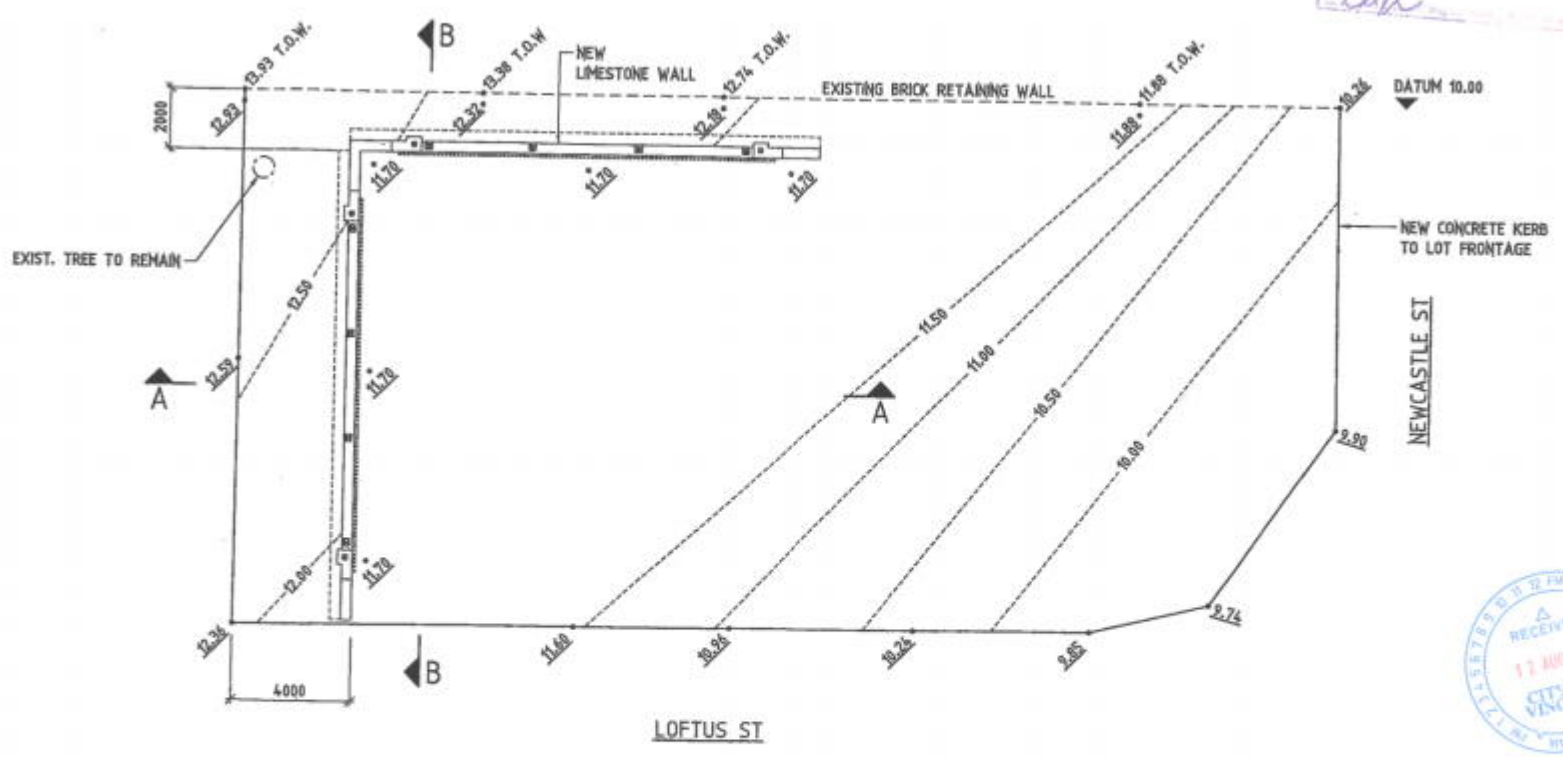

RECEIVED
 17 AUG 2009
 CITY OF VINCENT

SITE PLAN
 1:150

Town of Vincent
 22 DEC 2009
 Received

NO.	BY	DATE	DETAIL	PROJECT	DATE	DR. NO.	REV.			
D				LANDSCAPING & SIGNAGE TO LOT AT CORNER OF NEWCASTLE & LOFTUS ST	DRAWN	NAL	OCT '09			
C					CHECKED	L				
B				CLIENT	DESIGNED					
A	NAL	08/10/09	ISSUED FOR CONSTRUCTION		W.A. BILLBOARDS	APPROVED	<i>[Signature]</i>			
				CARNegie ASSOCIATES PTy LTD CONSULTING ENGINEERS STRUCTURAL DESIGN AND DRAFTING SPECIALISTS Unit 3 45 Huber Road Osborne Park Western Australia 6017 Tel 08 9244 1311 Fax 08 9244 1332 Email design@carnegie.com.au		DWG. NO.	SCALE	JOB No.	DWG. No.	REV.